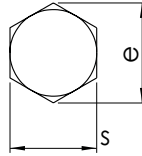
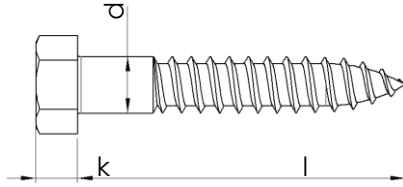

DIN 571**ALTİKÖŞE BAŞLI AĞAÇ VİDASI (TRİFON) HEXAGON
HEAD WOOD SCREW SECHSKANT-
HOLZSCHRAUBE****Technical Informations / Teknik Bilgiler**

Thread size / Anma çapı (d)		4	5	6	7	8	10	12	16	20
	Nominal	2,80	3,50	4,00	5,00	5,50	7,00	8,00	10,00	13,00
Head height / Kafa yüksekliği k	min.	2,50	3,13	3,63	4,63	5,13	6,55	7,55	9,55	12,10
	max.	3,10	3,88	4,38	5,38	5,88	7,45	8,45	10,45	13,90
Head width / Anahtar ağız s	min.	6,64	7,64	9,64	11,57	12,57	16,57	18,48	23,16	29,16
	max.	7,00	8,00	10,00	12,00	13,00	17,00	19,00	24,00	30,00
Diagonal / Köşegen e		7,50	8,63	10,89	13,07	14,20	18,72	20,88	26,17	32,95

Thread size / Anma çapı (d)		4	5	6	7	8	10	12	16	20
Length / Boy (l)										
16	15,10	16,90	1,71	2,92						
20	18,95	21,05	2,01	3,42	5,02					
25	23,95	26,05	2,41	4,02	5,82	11,50				
30	28,95	31,05	2,81	4,62	6,62	12,90	23,60			
35	33,75	36,25	3,11	5,12	7,42	14,20	25,80	36,20		
40	38,75	41,25	3,51	5,82	8,22	15,60	28,00	39,20		
45	43,75	46,25		6,43	8,94	16,90	30,00	42,10		
50	48,75	51,25		7,03	9,64	18,20	32,10	45,40	84,10	
55	53,50	56,50			10,50	19,60	34,30	48,60	89,70	
60	58,50	61,50			11,20	20,90	36,50	51,80	94,90	165,00
70	68,50	71,50				23,60	40,70	57,80	107,00	182,00
80	78,50	81,50				26,50	45,20	64,50	118,00	201,00
100	98,25	101,75				32,00	54,00	77,10	141,00	238,00
120	118,25	121,75						89,50	163,00	275,00
150	148,00	152,00							198,00	328,00

Values are given in millimeters. / Değerler milimetre olarak verilmiştir.